

PURPOSE

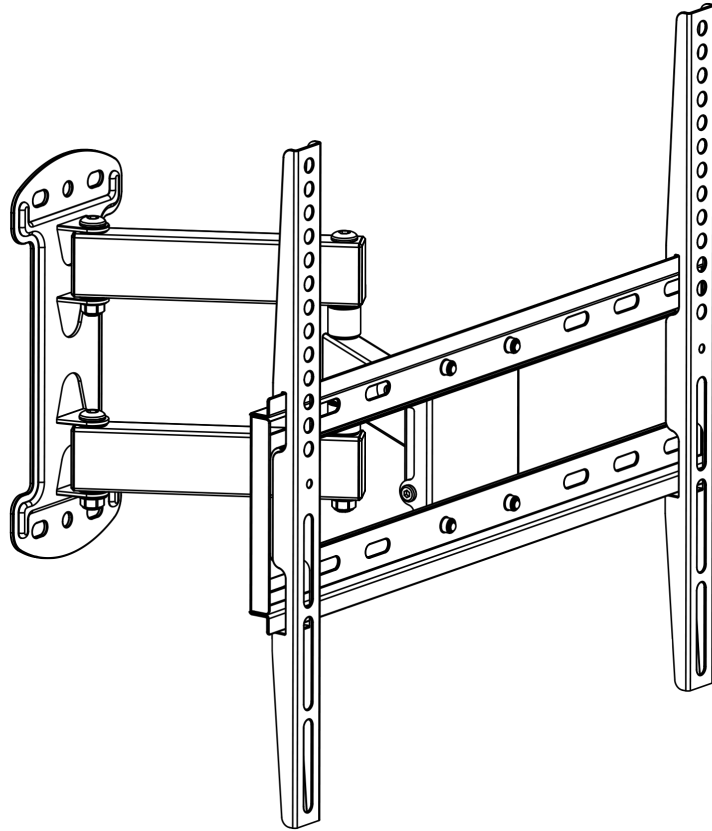

ASSEMBLY INSTRUCTION

MODEL: PAV-ART-S



PURPOSEAV™ - SINGLE ARM ARTICULATING MOUNT FOR 19-40" SIZED DISPLAYS



CAUTION

- Read and understand these instruction in their entirety prior to installation
- This mount supports 19-40" displays, up to VESA 400 x 400
- Maximum weight capacity: 66 lb (30 kg)
- Ensure that the mounting wall will safely support up to 4 times the total weight of the mount and display
- Use with products heavier than the maximum weights indicated may result in collapse of the mount and its accessories causing possible injury
- Installation by a qualified professional is highly recommended
- PurposeAV™ does not accept responsibility for incorrect installations



100% PERFORMANCE
GUARANTEE



DAILY IN-STOCK
PROMISE



SEAMLESS
SUPPORT



10 YEAR
WARRANTY



GIVES BACK
TO CHARITY

PACKAGE CONTENTS:

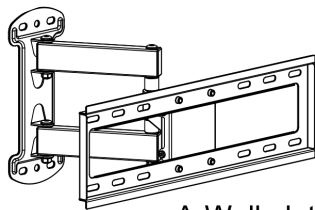

A-Wall plate unit
1pc



B-Bracket
2pcs

HARDWARE LIST:

H--Lag bolt 4pcs	I--Anchor 4pcs	J--M8 washer 4pcs	K--Allen key 1pc	a--M4X12 bolt 4pcs	b--M5X12 bolt 4pcs	c--M6X12 bolt 4pcs

d--M8X25 bolt 4pcs	e--M4X30 bolt 4pcs	f--M5X30 bolt 4pcs	g--M6X35 bolt 4pcs	h--M8X50 bolt 4pcs

i--M5/M6 spacer 4pcs	j--M8 spacer 4pcs	k--M5/M4 washer 4pcs	l--M6 washer 4pcs	m--10mm spacer 4pcs	n--2.5mm spacer 8pcs

REQUIRED TOOLS:

- Power Drill
- 2/5, 3/8", 7/32" drill bit
- Philips Head Screw Driver
- Socket Wrench
- Level
- Stud Finder

⚠ CAUTION :

SAFETY WARNING:

Never let children climb on product or play with product.

Do not sit or stand on product.

Do not fasten a TV that is heavier than the recommended load rating to the mount.

Using suitable concrete wall or wood stud wall.

Improper installation may cause property damage and/or personal injury, so the installation must be done by two qualified contractors. The manufacture is not liable for damage or injury caused by incorrect mounting, assembly or use.

Improper handling can result in cuts and lacerations.

Pictures for reference only, subject to our available products.

Keep this instruction for future reference.

⚠ CAUTION : This mount is intended for use with weights not exceeding "maximum weight capacity 66lbs." The wall itself has to be capable of supporting 4X standard weight. Pls don't over tighten screws in order to avoid any injury. Use with products heavier than the maximum weights indicated may result in collapse of the mount and its accessories causing possible injury.

INSTALLATION

STEP 1: MOUNT WALL PLATE UNIT

Mounting on a Stud Wall (2 adjacent studs)

- Locate the center of the studs using a stud finder and mark 4 holes
- Pre-drill top and bottom holes into the wood studs with a 7/32" drill bit to a depth of 2.5"
- Fix the wall plate by using the lag bolt screws (H) and washers (J) (Figure 1)

WARNING



Wood stud must be a minimum size of 2x4 inches. Lag bolts must be in the center of the stud. Do not over tighten lag bolts.

Wood Single Stud

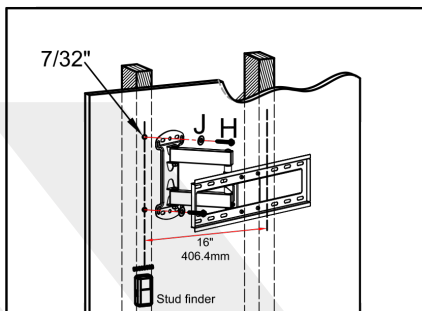

Figure 2

Mounting on a Concrete Wall

- Pre-drill 4 holes into the concrete using 3/8" drill bit to a depth of 2.5"
- Insert anchor (I) into each of the holes. Tap until flush with concrete surface
- Fix the wall plate by using the lag bolt screws (H) and washers (J) (Figure 2)

WARNING



Do not drill into mortar joints. Concrete must be a minimum of 2000 psi density in order to hold anchor. Ensure that the anchor is flush with concrete surface even if there is another layer of material. If layer of material is over 3/8", custom thicker lag bolts must be used. Do not over tighten lag bolts.

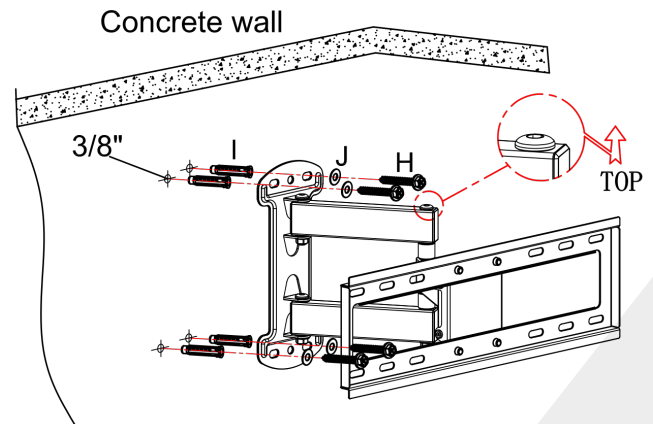

Figure 1

INSTALLATION

STEP 2: MOUNT ARMS TO DISPLAY

- Determine the correct screw size diameter for your TV mounting holes. Hand-thread one into the hole to determine the appropriate part to use. Stop if there is any resistance
- Thread screws into the washer -> arm -> spacer -> TV

WARNING



Using incorrect bolts may damage your TV. Ensure arms lie flat and square to the TV.

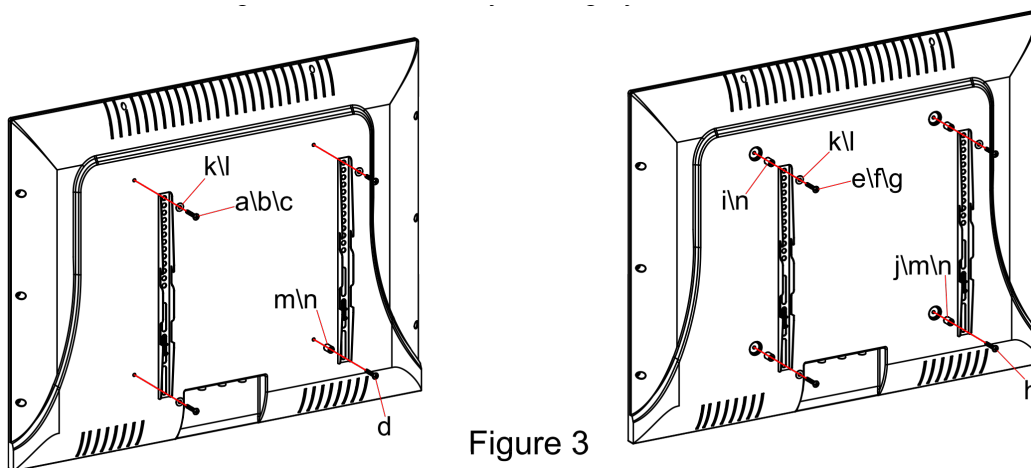

Figure 3

INSTALLATION

STEP 3: HANG DISPLAY ON WALL PLATE

- Lift the TV to hook the arms over the top of the wall plate so that it rests comfortably on the wall plate
- Tighten the screws located at the bottom of the arms to secure and lock the arm onto the plate

WARNING



Take caution when lifting the display onto the wall plate.

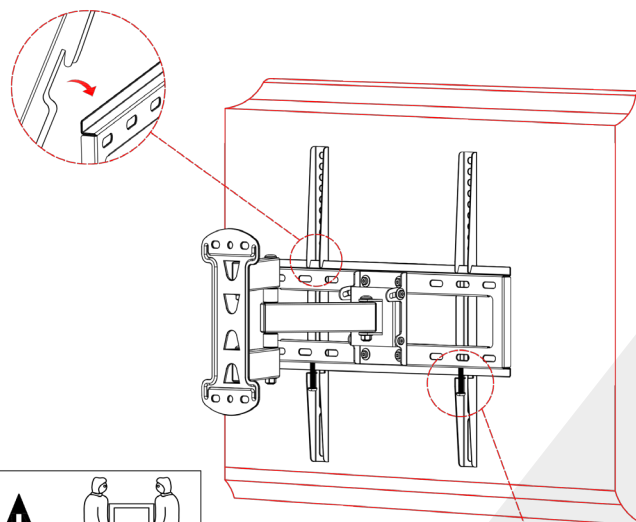
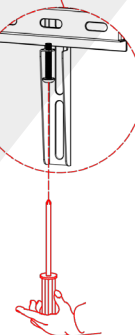
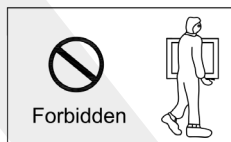
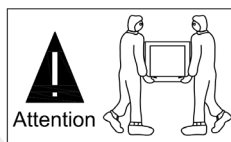

Figure 4



INSTALLATION

STEP 4: TILT ADJUSTMENT

- Adjust the tilt to the desired angle. It may be necessary to first loosen the screws to reduce tilt resistance
- Once desired tilt is met, tighten screws to lock in adjustment

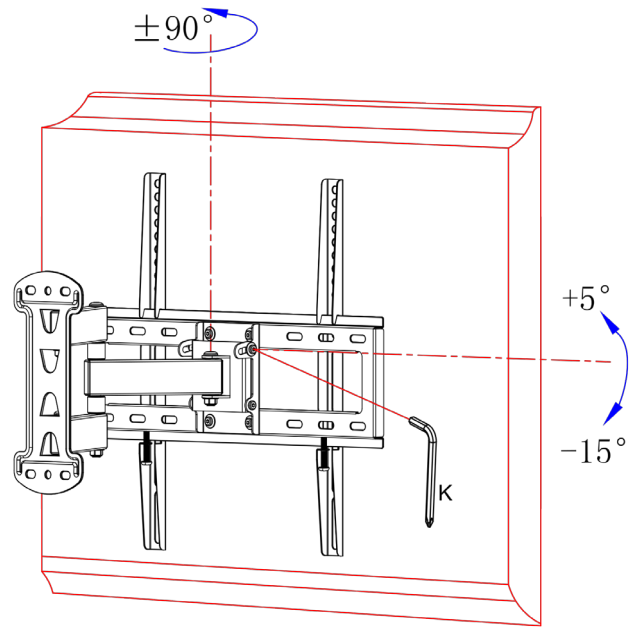

PAY EXTRA CARE AND ATTENTION WHEN YOU FASTEN TWO TV MOUNTS TO THE BACK PANEL OF TV IN STEP2. MAKE SURE THE APPROPRIATE MOUNT HARDWARE IS BEING USED PROPERLY.

1. Select correct Mounting Hardware according to the screw hole size of your TV, discard any remaining screws or spacers.
2. Carefully lay your TV on its face on a non-abrasive surface, making sure to lay padding underneath it so as not to damage the screen.
3. Place left TV mount and right mount in the appropriate position, making sure CENTERED on the back of the TV and LEVEL with on another.
4. This product only install on the perpendicular wall, not install on the ceiling.