

Picture perfect sound.®



TcUMB

INSTALLATION GUIDE





Visit us online for product support and installation guides.

www.leonspeakers.com

Questions?

Call Customer Service

1.888.213.5015

Mon-Fri 8am-6pm EST

TcUMB MOUNTING SYSTEM for SONOS PLAYBAR

Thank you for purchasing the ToneCase UMB Mounting System. The TcUMB is designed to attach the SONOS PLAYBAR directly to the display and offers multiple points of articulation for a perfectly flush installation. For more information, visit www.leonspeakers.com.

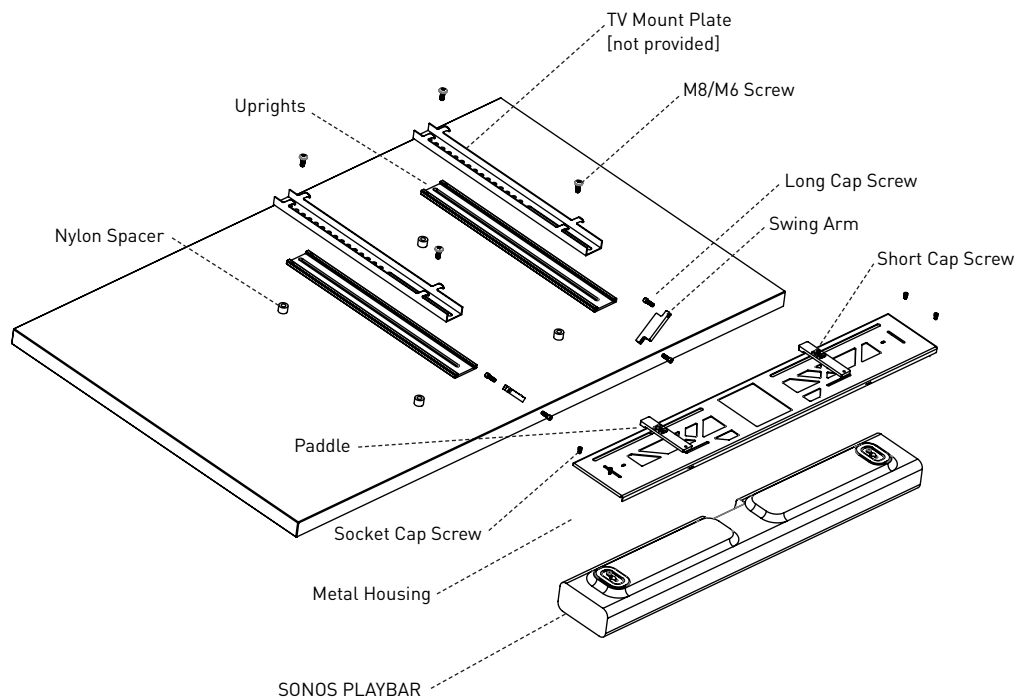

Exploded View

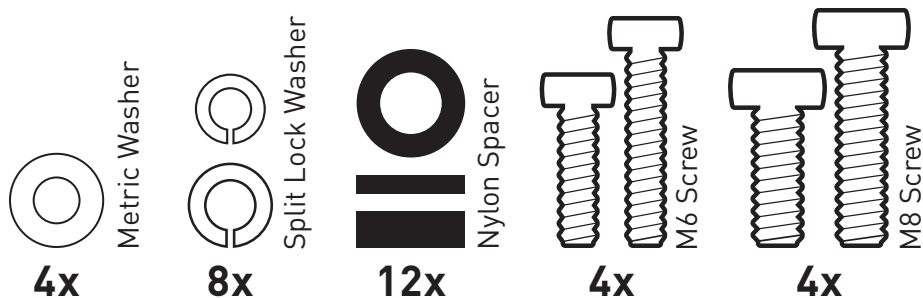

Universal TV Mount Hardware

Not to scale / Extra hardware included



Metal Housing for SONOS® PLAYBAR®

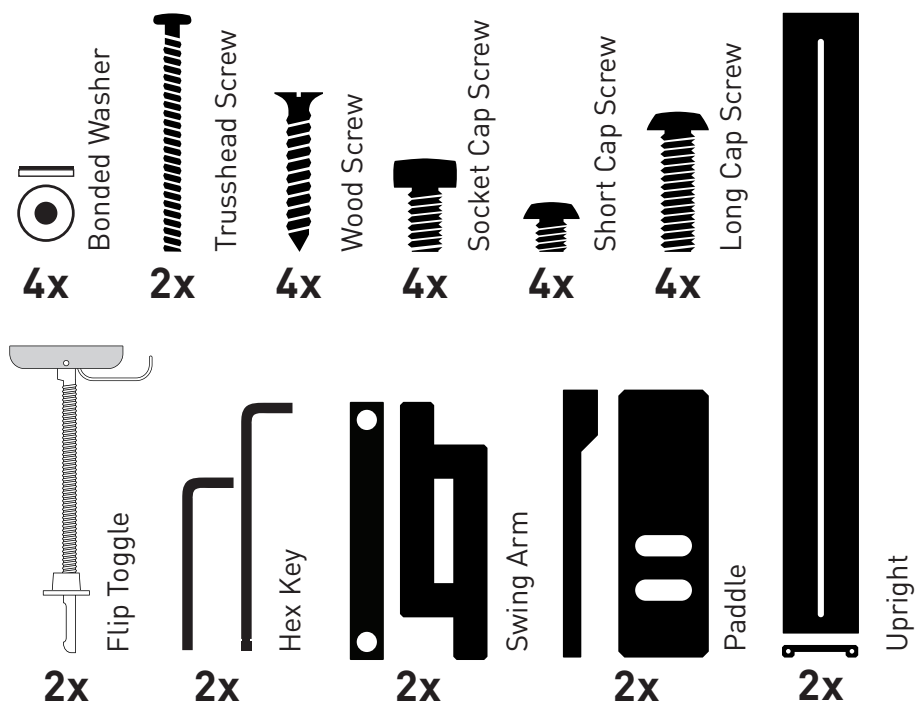

Bracket Hardware

*Not to Scale

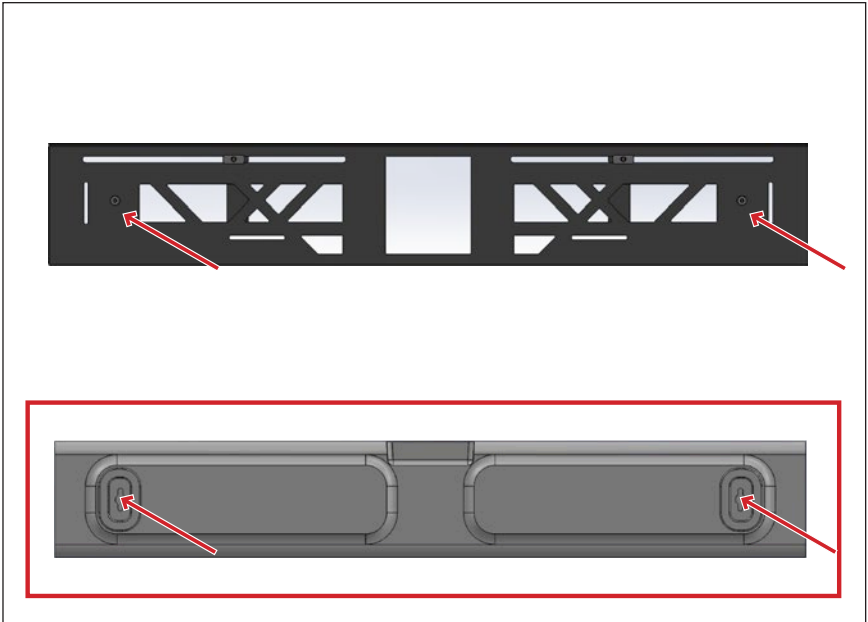

Mount SONOS Playbar to **Metal Housing**
using the keyhole on Playbar and
Brass Post on inside of the housing.

The long slot of the Metal Housing should be ON TOP.
Lateral adjustments can be made to the brass post if the
spacing does not line up with the keyholes on the Playbar.

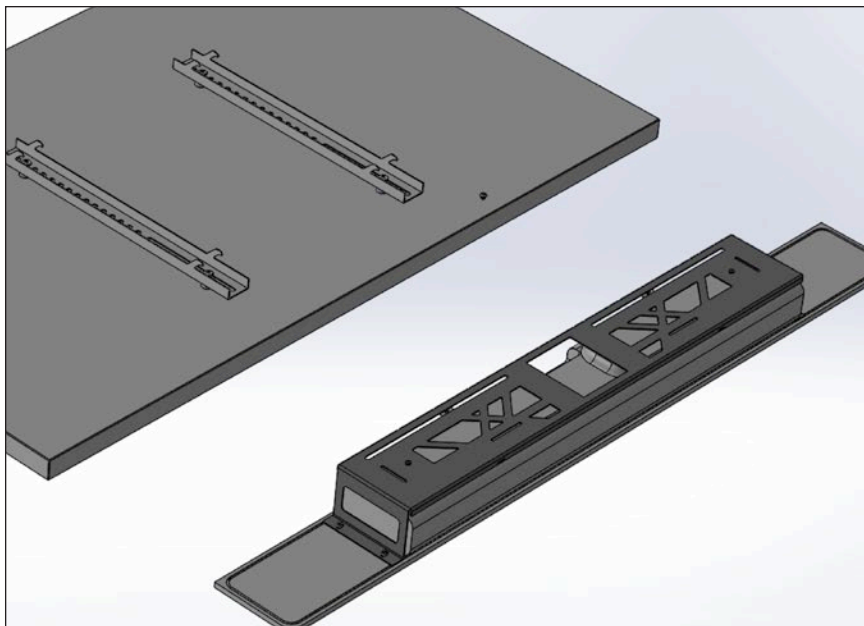

NOTE: Image above also shows custom grill, not included.

Place **TV & TcUMB** on clean, padded surface

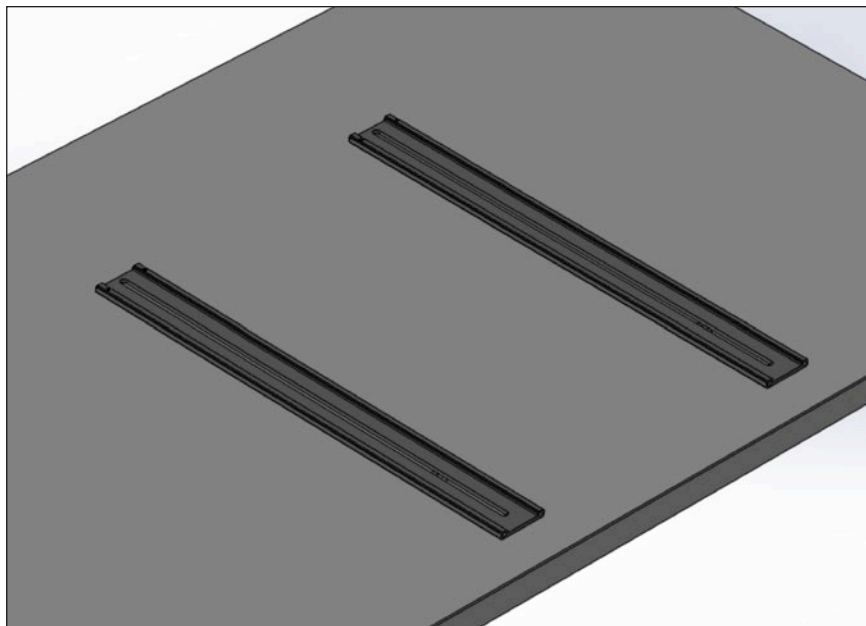

Align the **Uprights** with **TV Mount Holes**

*Mount Rails provided by TV mount manufacturer

*Use Nylon Spacers as needed



Uprights
2x



Nylon Spacer
4x/8x

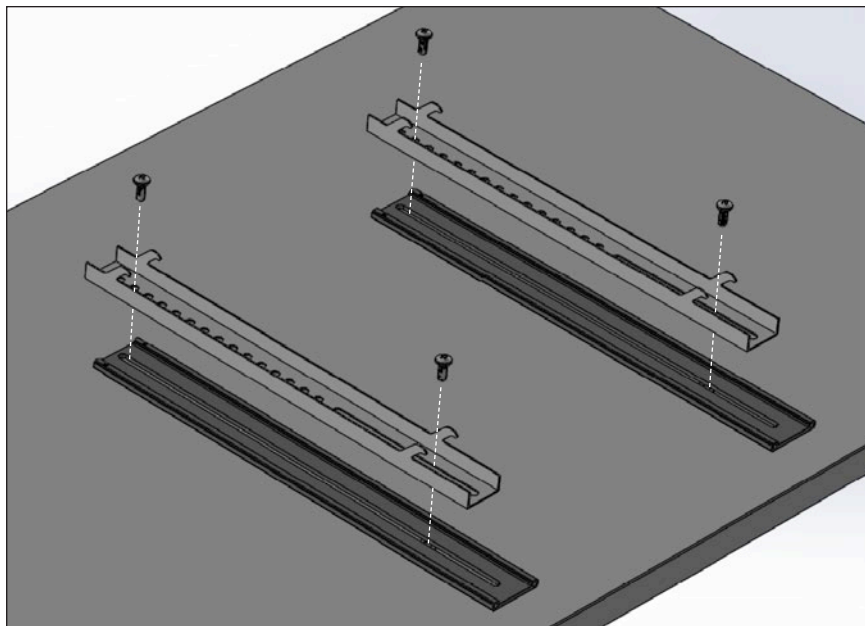

Affix **TV Mount Rails*** with **M6/M8 Screws** and **Split Lock Washers**

*Do not tighten screws completely
in order to adjust the **Uprights**

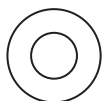

Metric Washer
4x



Split Lock Washer
4x



Nylon Spacer
4x/8x

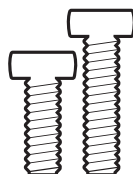

M8/M6 Screw
4x

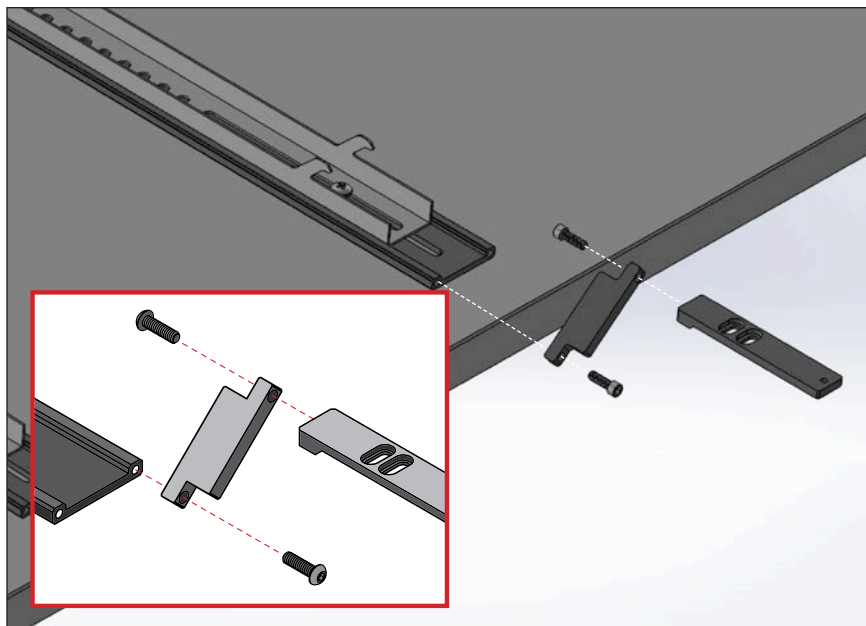

Attach **Swing Arms** to **Paddles**
and **Uprights** with **Long Cap Screws***

*Do not tighten **Long Cap Screws** completely



Swing Arm
2x



Paddle
2x



Long Cap Screw
4x

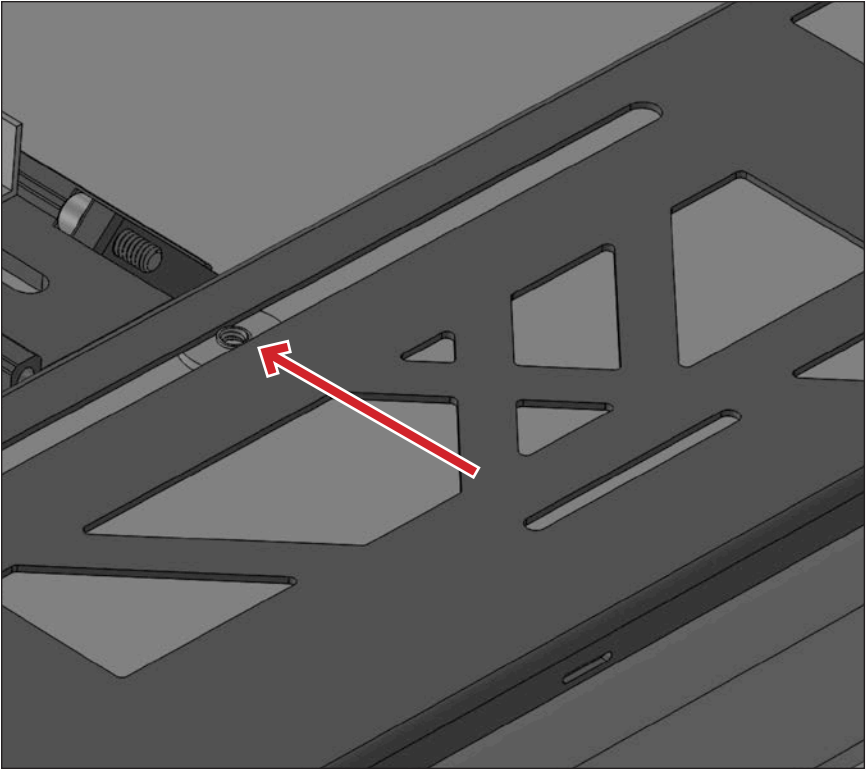

Locate **Square Nut** on **Metal Housing**
captured within top slot

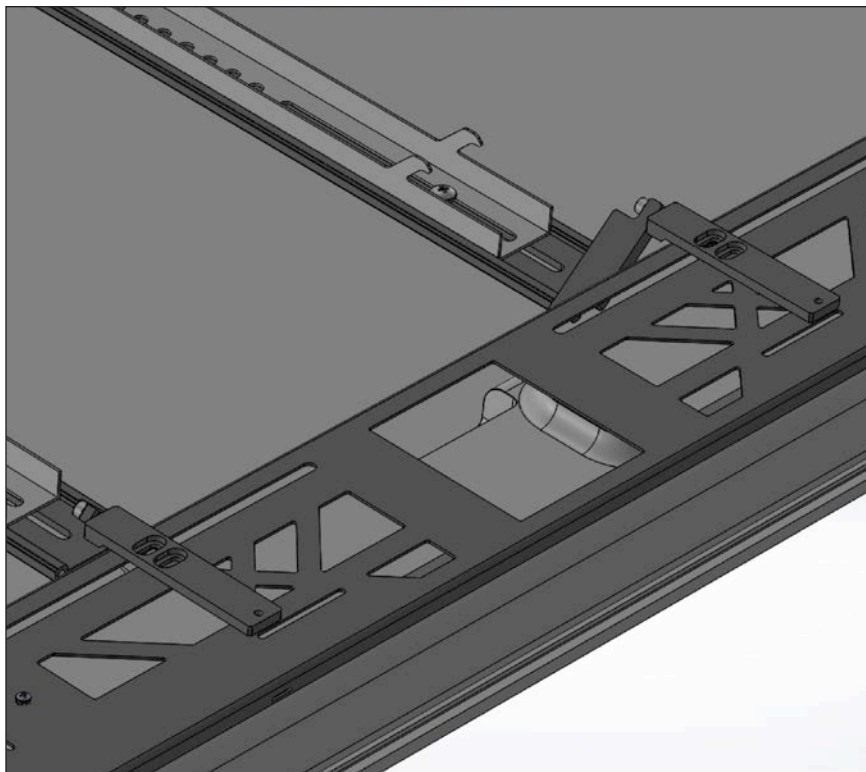

Slide **Metal Housing** forward until **Paddles**
rest flat on back of **Metal Housing**

*Allow 1"-2" space from bottom TV edge

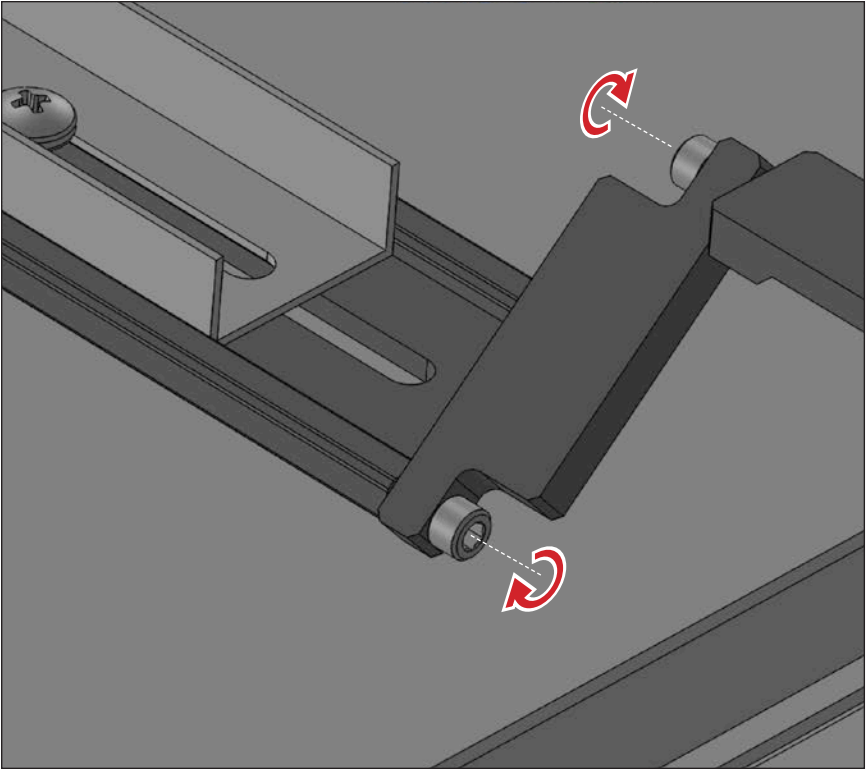

Tighten all 4 **Long Cap Screws**
to secure **Swing Arms/Paddles** in position

***Long Cap Screws** require extra torque

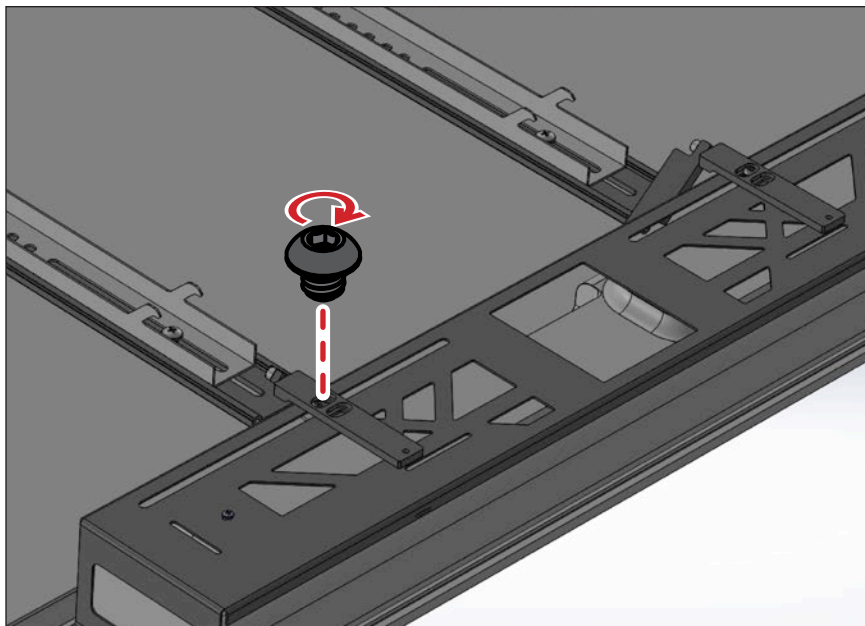

Slide **Metal Housing** flush with bottom of TV.
Attach **Paddles** to Metal Housing by screwing
Cap Screws into **Square Nuts**

***Square Nuts** are captured in slots on Metal Housing



Cap Screw
2x

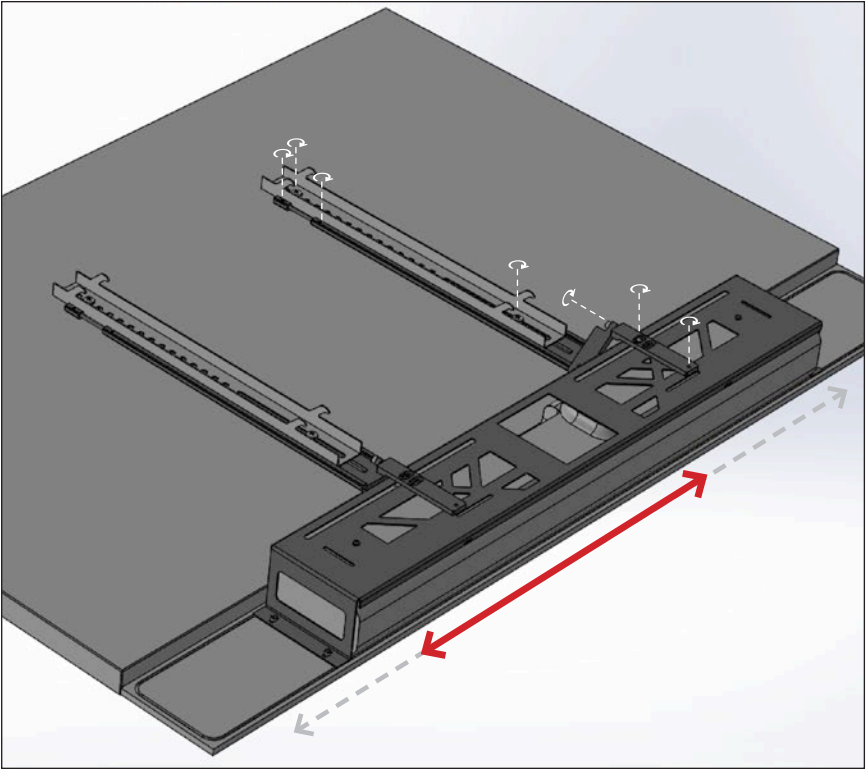

NOTE: Image above also shows custom grill, not included.

Make final adjustments to **Metal Housing**
and tighten all **screws & connections**.

Proceed to mount TV/speaker assembly.

IMPORTANT: Be sure to completely tighten the Uprights.
Some screws require extra torque.



Visit us online for product support and installation guides.

www.leonspeakers.com

Questions?

Call Customer Service

1.888.213.5015

Mon-Fri 8am-6pm EST



715 W. Ellsworth Road Ann Arbor, Michigan 48108 | 1.888.213.5015 | www.leonspeakers.com

Picture perfect sound.®